

TREE TOUR

Southern Sections

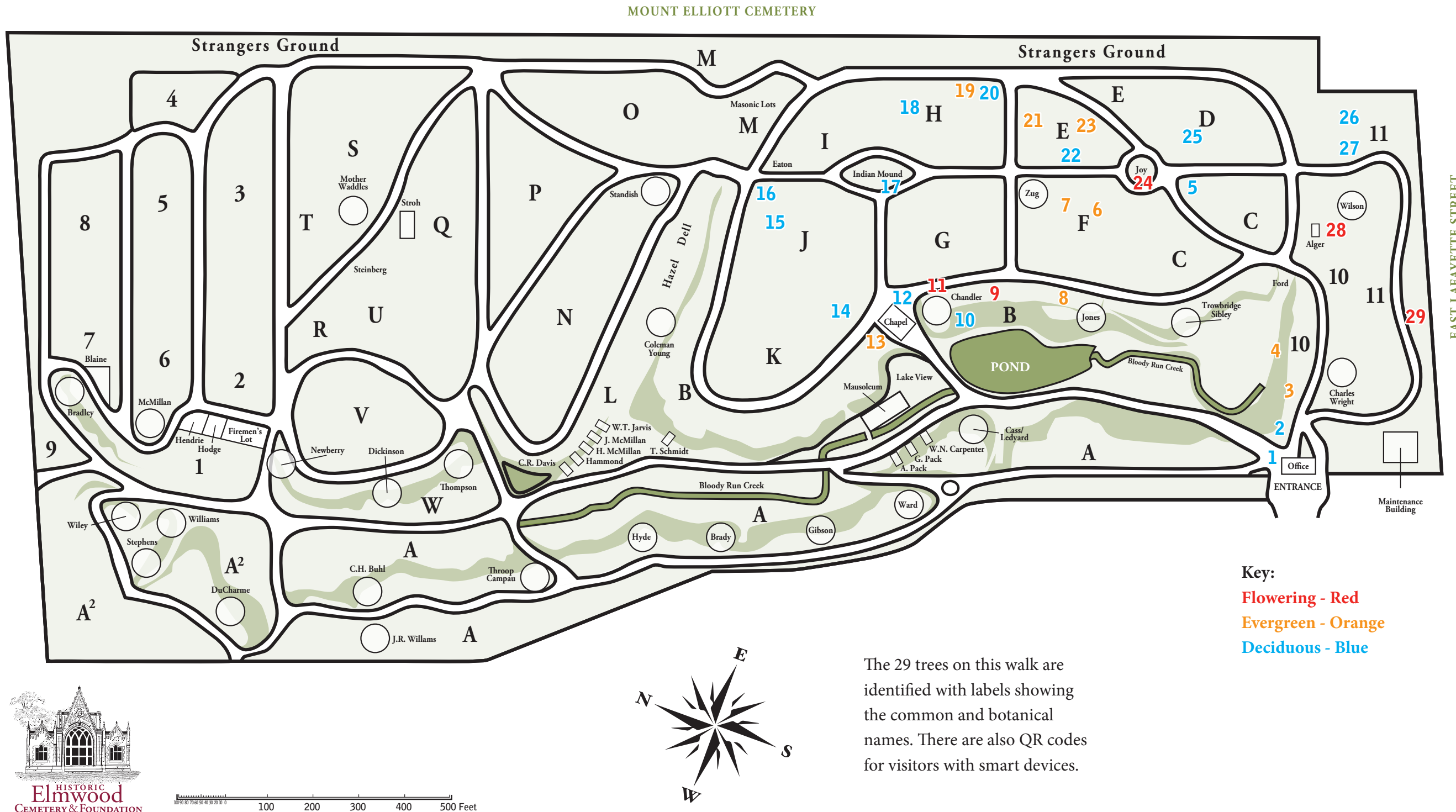

Key:
Flowering - Red
Evergreen - Orange
Deciduous - Blue

1. European Beech
2. Paperbark Maple
3. Anglo-Japanese Yew
4. Sycamore Maple
5. Amur Corktree
6. Colorado Spruce
7. River Birch
8. American Elm
9. Loebner Magnolia
10. Siberian Elm
11. Star Magnolia
12. Japanese Maple
13. White Pine
14. Littleleaf Linden
15. Pignut Hickory
16. European Hornbeam
17. Horsechestnut
18. Hackberry
19. Japanese Sawara Cypress
20. Silver Maple
21. Eastern Red Cedar
22. Paper Birch
23. Oriental Arborvitae
24. Callery Pear
25. Fleshy Hawthorn
26. Pin Oak
27. Kentucky Coffeetree
28. Apple Serviceberry
29. Apple

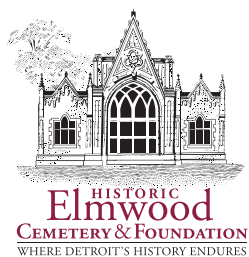

The 29 trees on this walk are identified with labels showing the common and botanical names. There are also QR codes for visitors with smart devices.

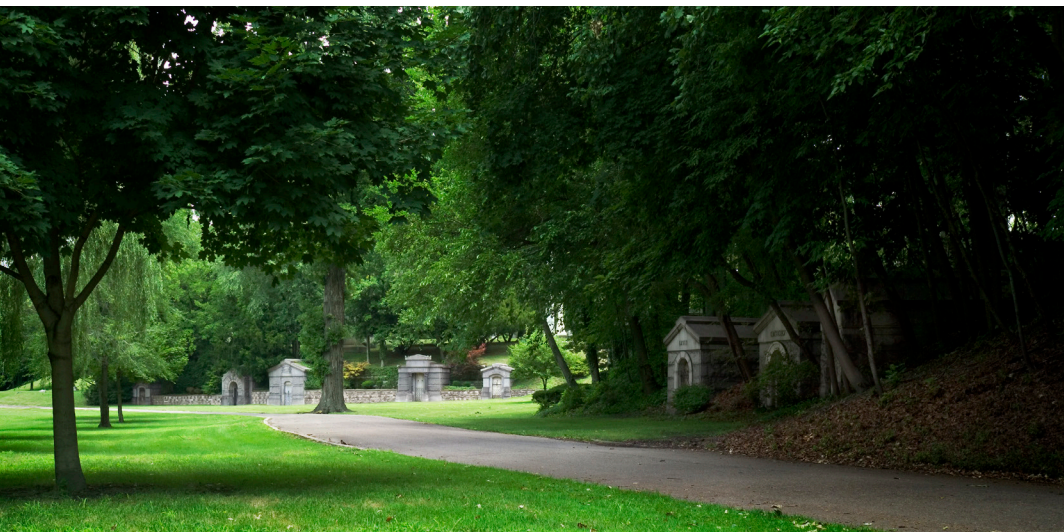

The Elmwood Family of Cemeteries

Elmwood Cemetery was established in 1846 and incorporated in 1849 as a non-profit corporation by an act of the Michigan Legislature. In the 1890s, prominent landscape architect Frederick Law Olmsted was hired to provide guidance to the cemetery Trustees on how best to re-design the grounds. The cemetery incorporated Michigan's native plants and trees that would thrive in our environment, large stands of trees to provide shade for visitors and roadways designed to follow the natural slope of the land. In 2015 Elmwood Cemetery was certified as a Level 1 Arboretum by Morton Arboretum and the ArbNet Arboretum Accreditation Program, making Elmwood Detroit's first certified arboretum. Visitors enjoy Elmwood's park-like setting every day of the year, using the grounds to walk, ride bikes, bird watch, picnic and of course contemplate the serenity of the area while visiting family.

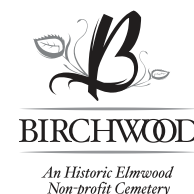
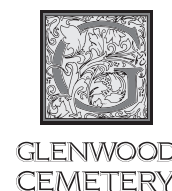
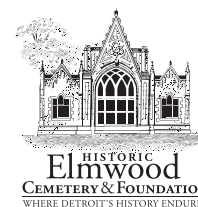

(313) 567-3453

1200 Elmwood Avenue Detroit, MI 48207

www.ElmwoodHistoricCemetery.org

HISTORIC Elmwood Cemetery

TREE TOUR: Southern Sections

